

# Drexel University – Academic Resource Center, First Floor

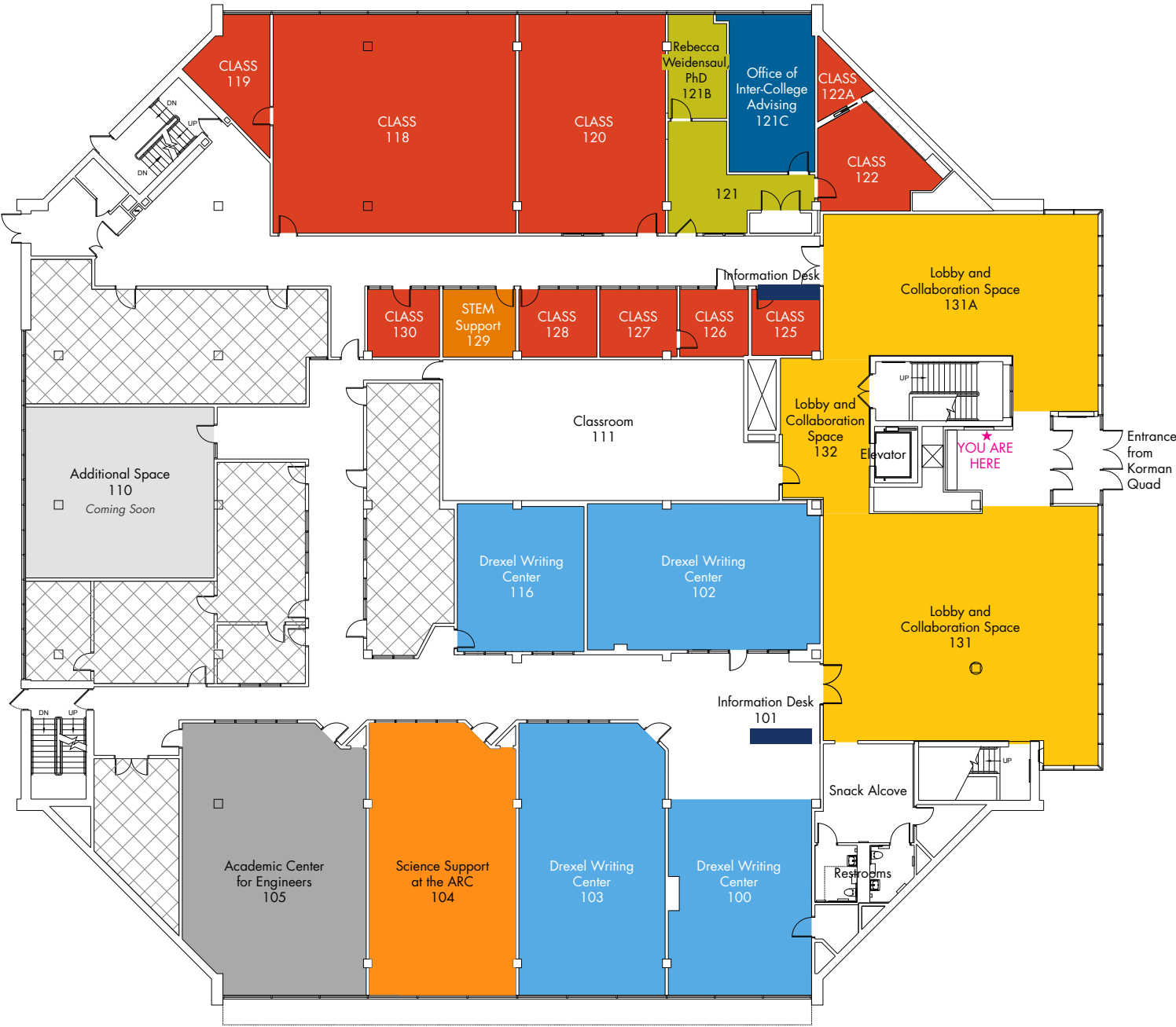

**Academic Center for Engineers** ..... 105  
 General tutoring for engineering majors

**Additional Space (Coming Soon)** ..... 110

**CLASS** ..... 118–120, 122, 122A & 125–130  
 Learning and study support  
 Nursing and health sciences tutoring

**Classroom** ..... 111

**Drexel Writing Center** ..... 100, 102, 103 & 116  
 Writing consultations for all courses and purposes

**Information Desk** ..... 101 & 125

**Lobby and Collaboration Space** . . 131, 131A & 132

**Office of Inter-College Advising** ..... 121C

**Office of Rebecca Weidensaul, PhD** ..... 121B

**Science Support at the ARC** ..... 104  
 Biology, chemistry, and physics support

**STEM Support** ..... 129  
 Bridge to the Doctorate  
 Louis Stokes Alliance for Minority Participation

# Drexel University – Academic Resource Center, Second Floor

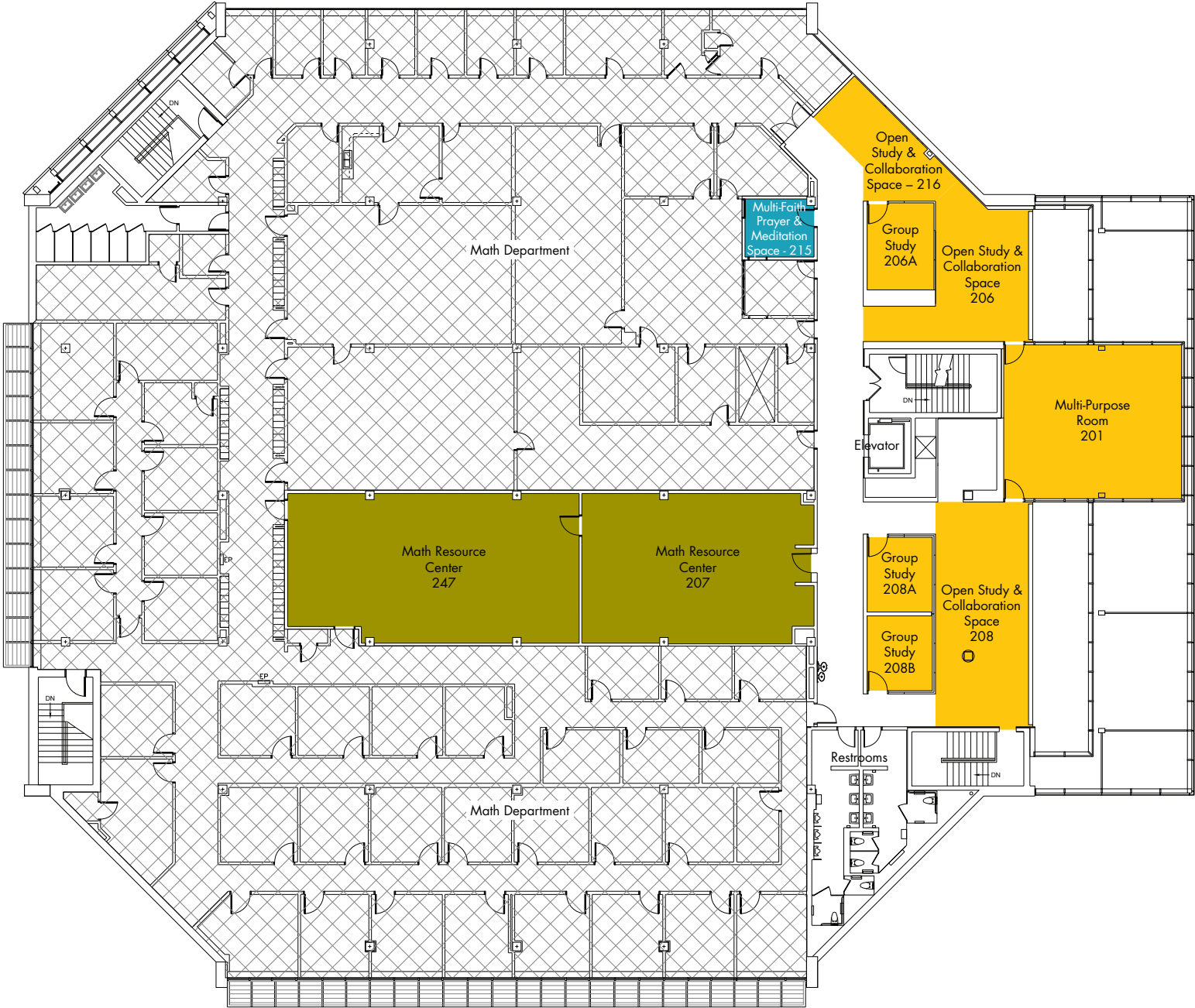

- Group Study** ..... 206A, 208A & 208B
- Math Resource Center** ..... 207 & 247  
Math tutoring
- Math Department** ..... 209-298
- Multi-Faith Prayer & Meditation Space** ..... 215
- Multi-Purpose Room** ..... 201
- Open Study & Collaboration Space** ..... 206, 208 & 216

# Drexel University – Resources Around Campus

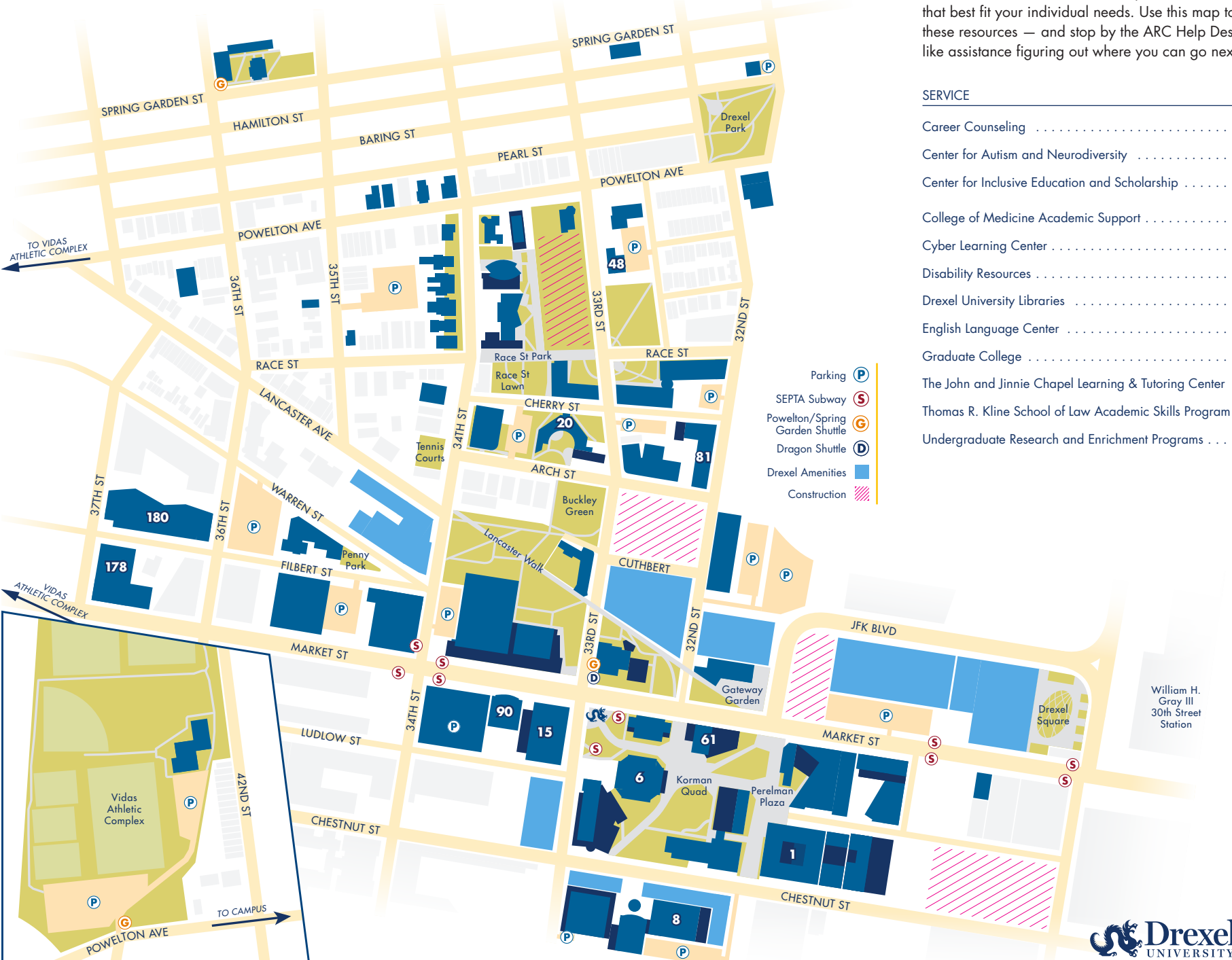

While most academic support services at Drexel can be found at the ARC in the Korman Center (Building 6), there are several other resources and offices around campus that can help you access the tools that best fit your individual needs. Use this map to help you navigate these resources — and stop by the ARC Help Desk in Korman if you'd like assistance figuring out where you can go next to get started.

SERVICE	BUILDING
Career Counseling	81 – Suite 110
Center for Autism and Neurodiversity	8 – Suite 048
Center for Inclusive Education and Scholarship	8 – Suite 222
College of Medicine Academic Support	180
Cyber Learning Center	178 – Room 1066
Disability Resources	1 – Suite 228
Drexel University Libraries	15
English Language Center	48
Graduate College	1 – Suite 301
The John and Jinnie Chapel Learning & Tutoring Center	61 – Third floor
Thomas R. Kline School of Law Academic Skills Program	90 – Rooms 351 & 353
Undergraduate Research and Enrichment Programs	20 – Second Floor

- Parking (P)
- SEPTA Subway (S)
- Powelton/Spring Garden Shuttle (G)
- Dragon Shuttle (D)
- Drexel Amenities (Blue)
- Construction (Pink Hatched)

William H. Gray III  
30th Street  
Station



3141 Chestnut Street,  
Philadelphia, PA 19104  
**DREXEL.EDU**